

DIGITAL CALIPER



1106-306A



1106-501

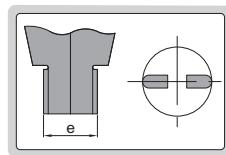

type A

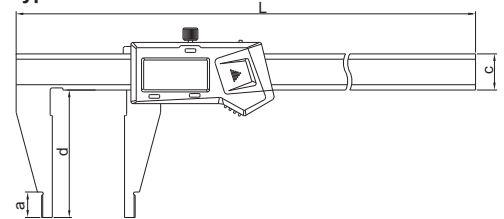

(mm)

Code	Range	Type	Accuracy	a	c	d	e	L
1106-256A	0-250mm/0-10"	A	±0.03mm	12	17	60	10	375
1106-306A	0-300mm/0-12"	A	±0.04mm	12	17	60	10	420
1106-301	0-300mm/0-12"	B	±0.05mm	12	24	100	20	420
1106-302	0-300mm/0-12"	B	±0.05mm	12	24	150	20	420
1106-451	0-450mm/0-18"	B	±0.05mm	18	24	100	20	625
1106-501	0-500mm/0-20"	B	±0.05mm	18	24	100	20	675
1106-502	0-500mm/0-20"	B	±0.06mm	18	24	150	20	675
1106-503	0-500mm/0-20"	B	±0.06mm	18	31	200	20	675
1106-505	0-500mm/0-20"	B	±0.08mm	18	42	300	20	675
1106-601	0-600mm/0-24"	B	±0.05mm	18	24	100	20	770
1106-602	0-600mm/0-24"	B	±0.06mm	18	24	150	20	770
1106-603	0-600mm/0-24"	B	±0.06mm	18	31	200	20	770
1106-802	0-800mm/0-32"	B	±0.07mm	24	31	150	20	1025
1106-1002	0-1000mm/0-40"	B	±0.08mm	24	31	150	20	1220
1106-1003	0-1000mm/0-40"	B	±0.08mm	24	31	200	20	1220
1106-1005	0-1000mm/0-40"	B	±0.10mm	24	42	300	20	1220
1106-1502	0-1500mm/0-60"	B	±0.11mm	24	42	150	20	1780
1106-1503	0-1500mm/0-60"	B	±0.12mm	24	42	200	20	1780
1106-2002	0-2000mm/0-80"	B	±0.14mm	24	42	150	20	2290
1106-2003	0-2000mm/0-80"	B	±0.14mm	24	42	200	20	2290

- Resolution: 0.01mm/0.0005"
- Buttons: on/off, zero, mm/inch
- Automatic power off, move the digital unit to turn on power
- Battery CR2032
- USB data output
- Made of stainless steel
- Optional accessory: SPC cable (page A1-A2)

type B

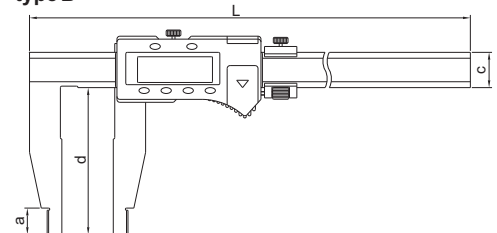

- Resolution: 0.01mm/0.0005"
- Button function: on/off, zero, mm/inch, ABS, data preset
- Absolute and incremental measurement
- Battery CR2032
- Data output
- Made of stainless steel
- Optional accessory: SPC cable (page A1-A2)