

# DIGITAL CALIPER



1117-306A



1117-501

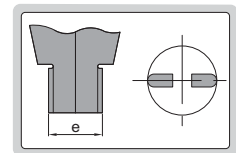

type A

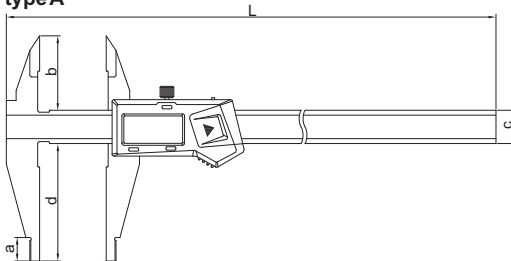

type B

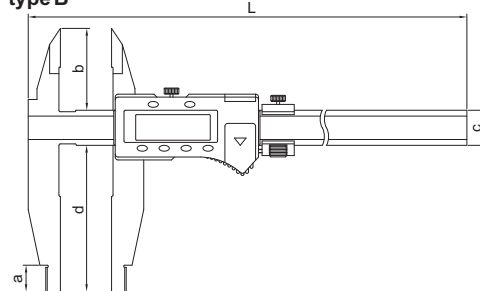

- Resolution: 0.01mm/0.0005"
- Buttons: on/off, zero, mm/inch
- Automatic power off, move the digital unit to turn on power
- Battery CR2032
- USB data output
- Made of stainless steel
- Optional accessory: SPC cable (page A1-A2)

- Resolution: 0.01mm/0.0005"
- Button function: on/off, zero, mm/inch, ABS, data preset
- Absolute and incremental measurement
- Battery CR2032
- Data output
- Made of stainless steel
- Optional accessory: SPC cable (page A1-A2)

(mm)

Code	Range	Type	Accuracy	a	b	c	d	e	L
1117-256A	0-250mm/0-10"	A	±0.03mm	12	38	17	60	10	375
1117-306A	0-300mm/0-12"	A	±0.04mm	12	38	17	60	10	420
1117-301	0-300mm/0-12"	B	±0.05mm	12	38	24	100	20	420
1117-501	0-500mm/0-20"	B	±0.05mm	18	56	24	100	20	675
1117-502	0-500mm/0-20"	B	±0.06mm	18	56	24	150	20	675
1117-601	0-600mm/0-24"	B	±0.05mm	18	56	24	100	20	770
1117-802	0-800mm/0-32"	B	±0.07mm	24	67	31	150	20	1025
1117-1002	0-1000mm/0-40"	B	±0.08mm	24	67	31	150	20	1220