

VERNIER CALIPER

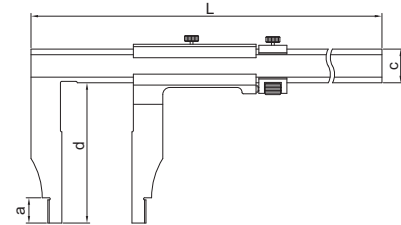

1208-611

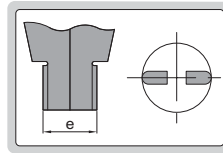

- With fine adjustment
- Made of stainless steel
- Satin chrome plated reading surface

Graduation 0.02mm (mm)

Code	Range	Accuracy	a	c	d	e	L
1208-211	0-200mm	±0.04mm	18	24	100	20	330
1208-391	0-300mm	±0.05mm	12	20	90	10	410
1208-321	0-300mm	±0.05mm	18	24	150	20	410
1208-511	0-500mm	±0.05mm	18	24	100	20	670
1208-521	0-500mm	±0.06mm	18	24	150	20	670
1208-611	0-600mm	±0.05mm	18	24	100	20	770
1208-621	0-600mm	±0.06mm	18	24	150	20	770
1208-821	0-800mm	±0.07mm	24	31	150	20	1030
1208-1021	0-1000mm	±0.08mm	24	31	150	20	1230
1208-1521	0-1500mm	±0.11mm	24	42	150	20	1820
1208-2021	0-2000mm	±0.14mm	24	42	150	20	2330

Graduation 0.05mm (mm)

Code	Range	Accuracy	a	c	d	e	L
1208-213	0-200mm	±0.06mm	18	24	100	20	330
1208-393	0-300mm	±0.07mm	12	20	90	10	410
1208-323	0-300mm	±0.07mm	18	24	150	20	410
1208-513	0-500mm	±0.07mm	18	24	100	20	670
1208-523	0-500mm	±0.08mm	18	24	150	20	670
1208-613	0-600mm	±0.08mm	18	24	100	20	770
1208-623	0-600mm	±0.09mm	18	24	150	20	770
1208-823	0-800mm	±0.09mm	24	31	150	20	1030
1208-1023	0-1000mm	±0.12mm	24	31	150	20	1230
1208-1523	0-1500mm	±0.16mm	24	42	150	20	1820
1208-2023	0-2000mm	±0.20mm	24	42	150	20	2330