

# DIAL SNAP GAUGE



dial indicator  
is not included

2184-50W

optional indicators



2308-10FA

2103-10F

2104-10F

Unit: mm

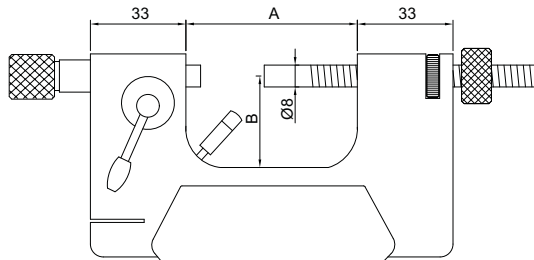

(mm)

Code	Range	A	B
2184-25W	0-25mm	34	18
2184-50W	0-50mm	62	32
2184-100W	50-100mm	112	62
2184-150W	100-150mm	162	85
2184-200W	150-200mm	212	110

- For quick Go/No-Go judgment of diameter of cylinders and shafts
- Anvil retracting stroke: 3mm
- Measuring force: 6-9N
- Carbide measuring faces
- Optional indicators:
  - dial indicator, range 0-10mm, graduation 0.01mm (code 2308-10FA)
  - digital indicator, range 0-12.7mm/0-0.5", resolution 0.001mm/0.00005" (code 2103-10F)
  - digital indicator, range 0-12.7mm/0-0.5", resolution 0.01mm/0.0005" (code 2104-10F)