

DIAL TEST INDICATOR



2380-08

- Jeweled bearing
- Carbide contact point
- Two measuring directions
- Anti magnetic body
- Supplied with two clamps: diameter $\varnothing 4\text{mm}$ and $\varnothing 8\text{mm}$
- Optional accessory: styli (page F 18)

Unit: mm

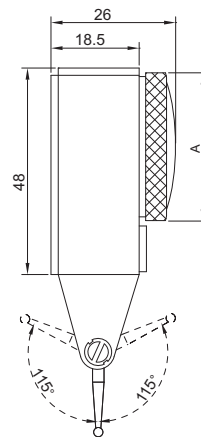
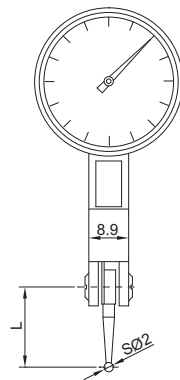

clamps

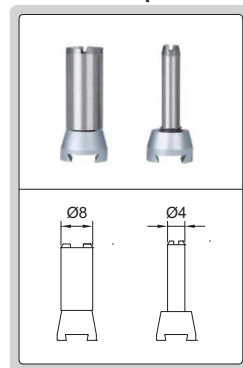

Code	Range	Graduation	Accuracy(f_{ges})	Hysteresis(f_u)	Dial reading	A	L
2380-08	0.8mm	0.01mm	13 μm	3 μm	0-40-0	$\varnothing 30\text{mm}$	16.5mm
2381-08	0.8mm	0.01mm	13 μm	3 μm	0-40-0	$\varnothing 37.5\text{mm}$	16.5mm
2380-02	0.2mm	0.002mm	6 μm	2 μm	0-100-0	$\varnothing 30\text{mm}$	16mm
2381-02	0.2mm	0.002mm	6 μm	2 μm	0-100-0	$\varnothing 37.5\text{mm}$	16mm