

45 ° SQUARE WITH WIDE BASE

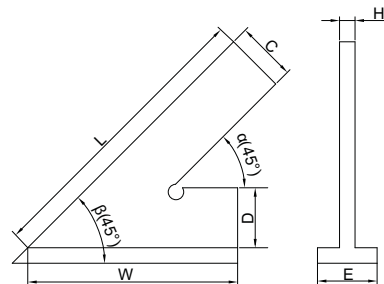

4747-100



(mm)

| Code | Size(LxW) | Accuracy | | C | D | H | E |
|----------|-----------|--------------------|--------------------|----|----|---|----|
| | | Inside(α) | Outside(β) | | | | |
| 4747-100 | 100x70mm | 27 μ m | 31 μ m | 20 | 20 | 5 | 20 |
| 4747-120 | 120x80mm | 29 μ m | 33 μ m | 20 | 20 | 5 | 20 |
| 4747-150 | 150x100mm | 32 μ m | 36 μ m | 20 | 20 | 5 | 20 |
| 4747-200 | 200x130mm | 36 μ m | 41 μ m | 25 | 25 | 5 | 25 |

- Made of hardened stainless steel